

	DIM 'A'	DIM 'B'	DIM 'C'	DIM 'D'	DIM 'E'	Pin 'C'
36P	7.65	25.00	6.00	12.30	8.15	A1,B17
64P	21.65	39.00	20.00	26.30	22.15	A1,B17,B31
98P	38.65	56.00	37.00	43.30	39.15	A1,B17,B31,B48
164P	71.65	89.00	70.00	76.30	72.15	A1,B17,B31,B48,B81

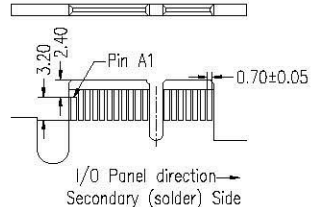
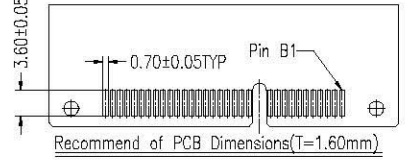
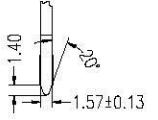
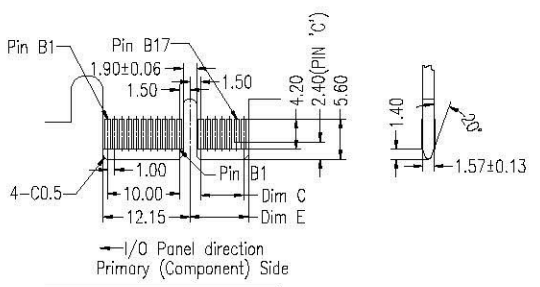
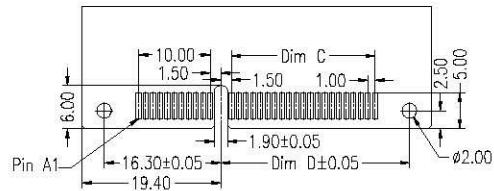
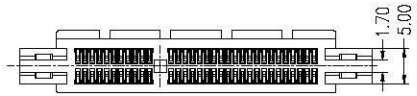
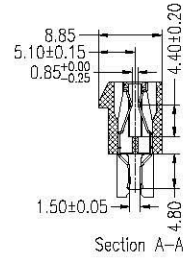
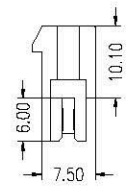
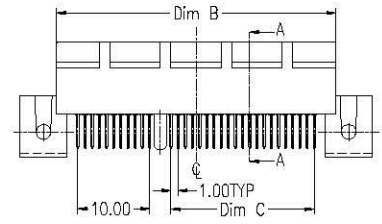
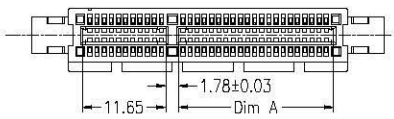

NOTES:

***Material**

Body : Nylon6T, UL 94V-0 Rated.
 Color: Black
 Contacts : Brass or Phosphor Bronze
 Plating: Gold plating over Nickel on contact Area;
 Tin plating on terminal.

***Mechanical**

Insertion Force: 1.15N max per contact pair;
 Withdrawal Force: 0.15N min per contact pair;
 Contact Retention Force: 4.9N min per contact;

***Electrical Specification**

Contact Resistance : 30 Milliohms Max.
 Current Resistance : 1 Ampere
 Insulation Resistance : 1000 Megohms Min, At 500V AC.

***Environmental**

Operating Temperature : -55°C to +105°C

PCIX-EF-xxx-LF
 LEADFREE
 RoHS Compliant

Allconnectors

www.allconnectors.de
 Tel.: 0049 711 7009503
 70734 Filderstadt - Germany

info@allconnectors.de
 Fax: 0049 711 7009504
 Kettnerstr. 25

PART NO. PCIX-EF-xxx

DWG NO. PCIX-EF-xxx

FILE NO.

UNIT / mm

SCALE 1:1

CHECKED BY CY

DRAWING BY

PROJECTION

TOLERANCES ARE

.X ± 0.2
 .XX ±
 .XXX ±
 AWG

DESCRIPTION:

AREA

PCI Express Connector Strip Form Pin
 Straddle (With Flange type)

REVISIONS

HK

DATE